





THIS DRAWING IS THE PROPERTY OF THE DESIGN ASSOCIATES INC. AND SHALL NOT BE COPIED OR USED IN ANY MANNER WITHOUT PRIOR PERMISSION.

**ELECTRICAL LEGEND :-**

SYMBOL	DESCRIPTION
	SWITCH BOARD
	TWO WAY SWITCH BOARD
	EM-TWO WAY SWITCH BOARD
	(1x18WATT) CFL LIGHT
	(1x18WATT) CFL EMERGENCY LIGHT
	CEILING FAN
	(1x15W) MIRROR LIGHT (LED)
	BRACKET LIGHT
	1x20W BULK HEAD LIGHT
	6A SWITCH SOCKET
	6/16A 5PIN SWITCH SOCKET
	CCTV
	6A SOCKET FOR CCTV
	LV JUNCTION BOX
	DISTRIBUTION BOARD
	25MM# CONDUIT FOR LIGHT
	25MM# CONDUIT FOR EMERGENCY
	25MM# CONDUIT FOR POWER
	25MM# CONDUIT FOR UPS
	25MM# CONDUIT FOR LV

NO. OF PRINTS	DATE	ISSUED TO	REMARKS
REVISION	DATE	DESCRIPTION	BY
R0	28.11.2017	FOR APPROVAL	NIKHIL TYAGI
R1	02.01.2018	FOR APPROVAL	NIKHIL TYAGI
R2	31.01.2018	FOR APPROVAL	NIKHIL TYAGI
R3	21.05.2018	FOR APPROVAL	NIKHIL TYAGI
R4	04.10.2019	FOR APPROVAL	BUNTY

ASSOCIATE ARCHITECTS-  
  
**DESIGN ASSOCIATES INC.**  
 ARCHITECTURE  
 A - 163, Sector - 136,  
 Noida - Greater Noida Expressway,  
 Noida - 201301  
 Email: sachin.agarwal@designassociates.in

MECHANICAL CONSULTANT-  
 ARK CONSULTANT, NEW DELHI  
 ELECTRICAL CONSULTANT-  
 ARK CONSULTANT, NEW DELHI  
 PLUMBING CONSULTANT-  
 ARK CONSULTANT, NEW DELHI  
 STRUCTURE CONSULTANT-  
 CE CON ENGG., NEW DELHI

PROJECT-  
**COMMERCIAL COMPLEX  
 AT POLO MARKET  
 SHILLONG**

DRAWING TITLE-  
**THIRD FLOOR PLAN  
 DB DETAIL LAYOUT**

DRAWING PURPOSE-  
**FOR TENDER PURPOSES ONLY**

JOB NO. -	DWG. REF. NO. -	DATE -
-----	-----	29-12-2017
SCALE -	REVISION -	DATE OF ISSUE -
1:150	R4	04.10.2019

DWG. NO. - **EL-114**

	SHEET SIZE -	SHEET NO. -
	A1	-----
	DRAWN BY -	CHECKED BY -
	BUNTY	PANKAJ

DISTRIBUTION BOARD:-LPDB-T		6 WAY SPN		LOC:-THIRD FLOOR			
CKT. NO.	WIRE SIZE IN SQ. MM."CU"	SP MCB'S IN AMPS	LOCATION	LOAD IN WATTS		B PHASE	
				R PHASE	Y PHASE		
T1	2x1.5+1x1.5(E)	10	CORRIDOR AREA	07		140	
T2	2x1.5+1x1.5(E)	10	CORRIDOR AREA	08		160	
T3	2x1.5+1x1.5(E)	10	CORRIDOR AREA	09		180	
T4	2x1.5+1x1.5(E)	10	CORRIDOR AREA	09		180	
T5	2x1.5+1x1.5(E)	10	TOILET	12	320		
T6	2x1.5+1x1.5(E)	10	CORRIDOR AREA	07	140		
T7	2x1.5+1x1.5(E)	10	CORRIDOR AREA	09	180		
T8	2x1.5+1x1.5(E)	10	TOILET	12	320		
T9	2x1.5+1x1.5(E)	10	CORRIDOR AREA	07	140		
T10	2x1.5+1x1.5(E)	10	CORRIDOR AREA	06	120		
T11	2x1.5+1x1.5(E)	10	TOILET	12	260		
T12	2x1.5+1x1.5(E)	10	TOILET	12	240		
T13			SPARE				
T14			SPARE				
T15			SPARE				
T16			SPARE				
T17			SPARE				
T18			SPARE				
FROM:	INCOMING : 25 AMP TPN MCB & 3 NOS 25 AMPS TPN RCCB 2x2.5+1X1.5 Cu. WIRE IN 32mm Ø CONDUIT			TOTAL	580W	1140W	660W
				GRAND TOTAL	2.38 KW		2380W

DISTRIBUTION BOARD:-UPSDB-D		8 WAY SPN		LOC:-THIRD FLOOR		
CKT. NO.	WIRE SIZE IN SQ. MM."CU"	SP MCB'S IN AMPS	LOCATION	LOAD IN WATTS		
				R PHASE	Y PHASE	
D1	2x1.5+1x1.5(E)	10	CORRIDOR AREA	05	100	
D2	2x1.5+1x1.5(E)	10	CORRIDOR AREA	10	200	
D3	2x1.5+1x1.5(E)	10	CORRIDOR AREA	12	240	
D4	2x1.5+1x1.5(E)	10	STARE & CORRIDOR	04	400	
D5			SPARE			
D6			SPARE			
D7			SPARE			
D8			SPARE			
FROM:	INCOMING : 25 AMP DP MCB WITH 25 AMPS DP RCCB 2x2.5+1X1.5 IN 32mmØ CONDUIT			TOTAL	1480W	
				GRAND TOTAL	1.48 KW	

NOTES FOR ELECTRICAL

1. THE SIZE OF WIRES FROM SWITCH BOARD TO DIFFERENT LIGHT AND FAN POINTS SHALL BE 1.5 SQ. M.M.
2. 5 AMP. PLUG SHALL BE CONNECTED TO THE LIGHTING CKT. OF THAT AREA.
3. THE CONDUITS USED FOR WIRING SHALL BE AS FOLLOWS :  
 SAME CONDUIT.  
 a) HEAVY DUTY (2 MM THICK) : IN R.C.C. SLAB  
 b) MEDIUM DUTY (1.5 MM THICK) : IN BRICK WALL
4. NO TWO DIFFERENT PHASE CIRCUIT / WIRE SHALL RUN TOGETHER THROUGH
5. LIGHT AND POWER CIRCUIT SHALL BE DRAWN THROUGH SEPARATE CONDUIT.
6. WIRING SHALL BE CARRIED OUT AS PER COLOUR CODE i.e. R, Y, B PHASES AND BLACK - NEUTRAL AND GREEN - EARTH.
7. THE POSITION MENTIONED IN LEGEND IS BOTTOM OF SWITCH BOARD / OUTLETS.
8. 230MM THICK WALL REQUIRED FOR DB MOUNTING.



THIS DRAWING IS THE PROPERTY OF THE DESIGN ASSOCIATES INC. AND SHALL NOT BE COPIED OR USED IN ANY MANNER WITHOUT PRIOR PERMISSION.

**ELECTRICAL LEGEND :-**

SYMBOL	DESCRIPTION
	SWITCH BOARD
	TWO WAY SWITCH BOARD
	EM-TWO WAY SWITCH BOARD
	(1x18WATT) CFL LIGHT
	(1x18WATT) CFL EMERGENCY LIGHT
	CEILING FAN
	(1x15W) MIRROR LIGHT (LED)
	BRACKET LIGHT
	1x20W BULK HEAD LIGHT
	6A SWITCH SOCKET
	6/16A 5PIN SWITCH SOCKET
	CCTV
	6A SOCKET FOR CCTV
	LV JUNCTION BOX
	DISTRIBUTION BOARD
	25MM# CONDUIT FOR LIGHT
	25MM# CONDUIT FOR EMERGENCY
	25MM# CONDUIT FOR POWER
	25MM# CONDUIT FOR UPS
	25MM# CONDUIT FOR LV

NO. OF PRINTS	DATE	ISSUED TO	REMARKS
REVISION	DATE	DESCRIPTION	BY
R0	28.11.2017	FOR APPROVAL	NIKHIL TYAGI
R1	02.01.2018	FOR APPROVAL	NIKHIL TYAGI
R2	31.01.2018	FOR APPROVAL	NIKHIL TYAGI
R3	21.05.2018	FOR APPROVAL	NIKHIL TYAGI
R4	04.10.2019	FOR APPROVAL	BUNTY

ASSOCIATE ARCHITECTS-  
**DESIGN ASSOCIATES INC.**  
 ARCHITECTURE  
 A - 163, Sector - 136,  
 Noida - Greater Noida Expressway,  
 Noida - 201301  
 Email: sachin.agarwal@designassociates.in

MECHANICAL CONSULTANT-  
 ARK CONSULTANT, NEW DELHI  
 ELECTRICAL CONSULTANT-  
 ARK CONSULTANT, NEW DELHI  
 PLUMBING CONSULTANT-  
 ARK CONSULTANT, NEW DELHI  
 STRUCTURE CONSULTANT-  
 CE CON ENGG., NEW DELHI  
 PROJECT-

**COMMERCIAL COMPLEX  
 AT POLO MARKET  
 SHILLONG**

DRAWING TITLE-  
**THIRD FLOOR PLAN  
 LIGHTING LAYOUT**

DRAWING PURPOSE-  
**FOR TENDER PURPOSES ONLY**

JOB NO. -	DWG. REF. NO. -	DATE-
-----	-----	29-12-2017
SCALE-	REVISION-	DATE OF ISSUE-
1:150	R4	04.10.2019
DWG. NO.-	EL-112	
	SHEET SIZE- A1	SHEET NO- -----
	DRAWN BY- BUNTY	CHECKED BY- PANKAJ

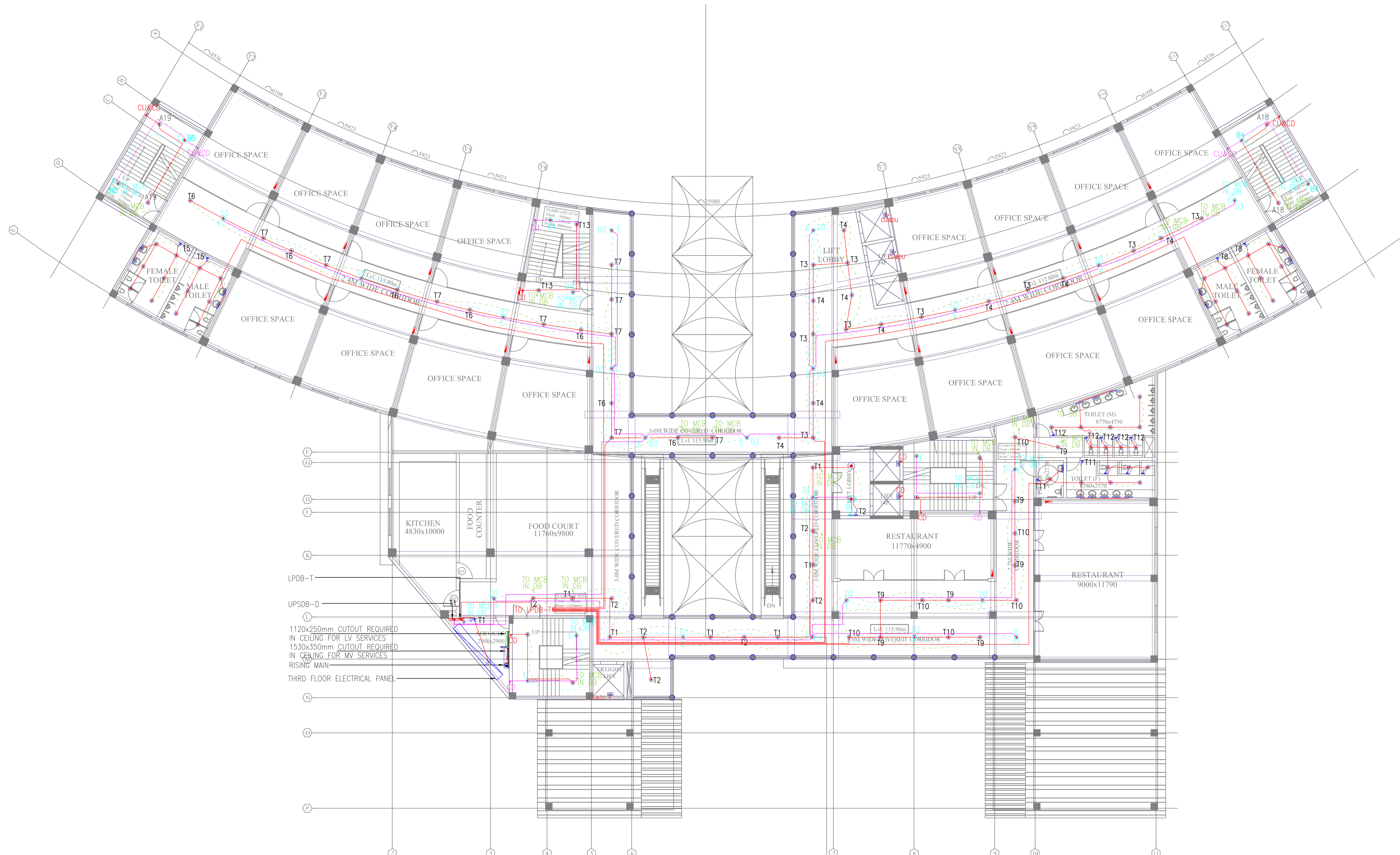

THIRD FLOOR PLAN

- NOTES FOR ELECTRICAL**
1. THE SIZE OF WIRES FROM SWITCH BOARD TO DIFFERENT LIGHT AND FAN POINTS SHALL BE 1.5 SQ. M.M.
  2. 5 AMP. PLUG SHALL BE CONNECTED TO THE LIGHTING CKT. OF THAT AREA.
  3. THE CONDUITS USED FOR WIRING SHALL BE AS FOLLOWS :  
 SAME CONDUIT.  
 a) HEAVY DUTY (2 MM THICK) : IN R.C.C. SLAB  
 b) MEDIUM DUTY (1.5 MM THICK) : IN BRICK WALL
  4. NO TWO DIFFERENT PHASE CIRCUIT / WIRE SHALL RUN TOGETHER THROUGH
  5. LIGHT AND POWER CIRCUIT SHALL BE DRAWN THROUGH SEPARATE CONDUIT.
  6. WIRING SHALL BE CARRIED OUT AS PER COLOUR CODE I.E. R, Y, B PHASES AND BLACK - NEUTRAL AND GREEN - EARTH.
  7. THE POSITION MENTIONED IN LEGEND IS BOTTOM OF SWITCH BOARD / OUTLETS.
  8. 230MM THICK WALL REQUIRED FOR DB MOUNTING.

THIS DRAWING IS THE PROPERTY OF THE DESIGN ASSOCIATES INC. AND SHALL NOT BE COPIED OR USED IN ANY MANNER WITHOUT PRIOR PERMISSION.

**ELECTRICAL LEGEND :-**

SYMBOL	DESCRIPTION
	SWITCH BOARD
	TWO WAY SWITCH BOARD
	EM-TWO WAY SWITCH BOARD
	(1x18WATT) CFL LIGHT
	(1x18WATT) CFL EMERGENCY LIGHT
	CEILING FAN
	(1x15W) MIRROR LIGHT (LED)
	BRACKET LIGHT
	1x20W BULK HEAD LIGHT
	6A SWITCH SOCKET
	6/16A SPIN SWITCH SOCKET
	CCTV
	6A SOCKET FOR CCTV
	LV JUNCTION BOX
	DISTRIBUTION BOARD
	25MM# CONDUIT FOR LIGHT
	25MM# CONDUIT FOR EMERGENCY
	25MM# CONDUIT FOR POWER
	25MM# CONDUIT FOR UPS
	25MM# CONDUIT FOR LV

NO. OF PRINTS	DATE	ISSUED TO	REMARKS
REVISION	DATE	DESCRIPTION	BY
R0	28.11.2017	FOR APPROVAL	NIKHIL TYAGI
R1	02.01.2018	FOR APPROVAL	NIKHIL TYAGI
R2	31.01.2018	FOR APPROVAL	NIKHIL TYAGI
R3	21.05.2018	FOR APPROVAL	NIKHIL TYAGI
R4	04.10.2019	FOR APPROVAL	BUNTY

ASSOCIATE ARCHITECTS-

**DESIGN ASSOCIATES INC.**  
ARCHITECTURE

A - 163, Sector - 136,  
Noida - Greater Noida Expressway,  
Noida - 201301  
Email: sachin.agarwal@designassociates.in

MECHANICAL CONSULTANT-  
ARK CONSULTANT, NEW DELHI

ELECTRICAL CONSULTANT-  
ARK CONSULTANT, NEW DELHI

PLUMBING CONSULTANT-  
ARK CONSULTANT, NEW DELHI

STRUCTURE CONSULTANT-  
CE CON ENGG., NEW DELHI

PROJECT-

**COMMERCIAL COMPLEX  
AT POLO MARKET  
SHILLONG**

DRAWING TITLE-  
**THIRD FLOOR PLAN  
POWER & LV & UPS LAYOUT**

DRAWING PURPOSE-  
**FOR TENDER PURPOSES ONLY**

JOB NO. -	DWG. REF. NO. -	DATE-
-----	-----	29-12-2017

SCALE-	REVISION-	DATE OF ISSUE-
1:150	R4	04.10.2019

DWG. NO.- EL-113

	SHEET SIZE-	SHEET NO-
	A1	-----
	DRAWN BY-	CHECKED BY-
	BUNTY	PANKAJ

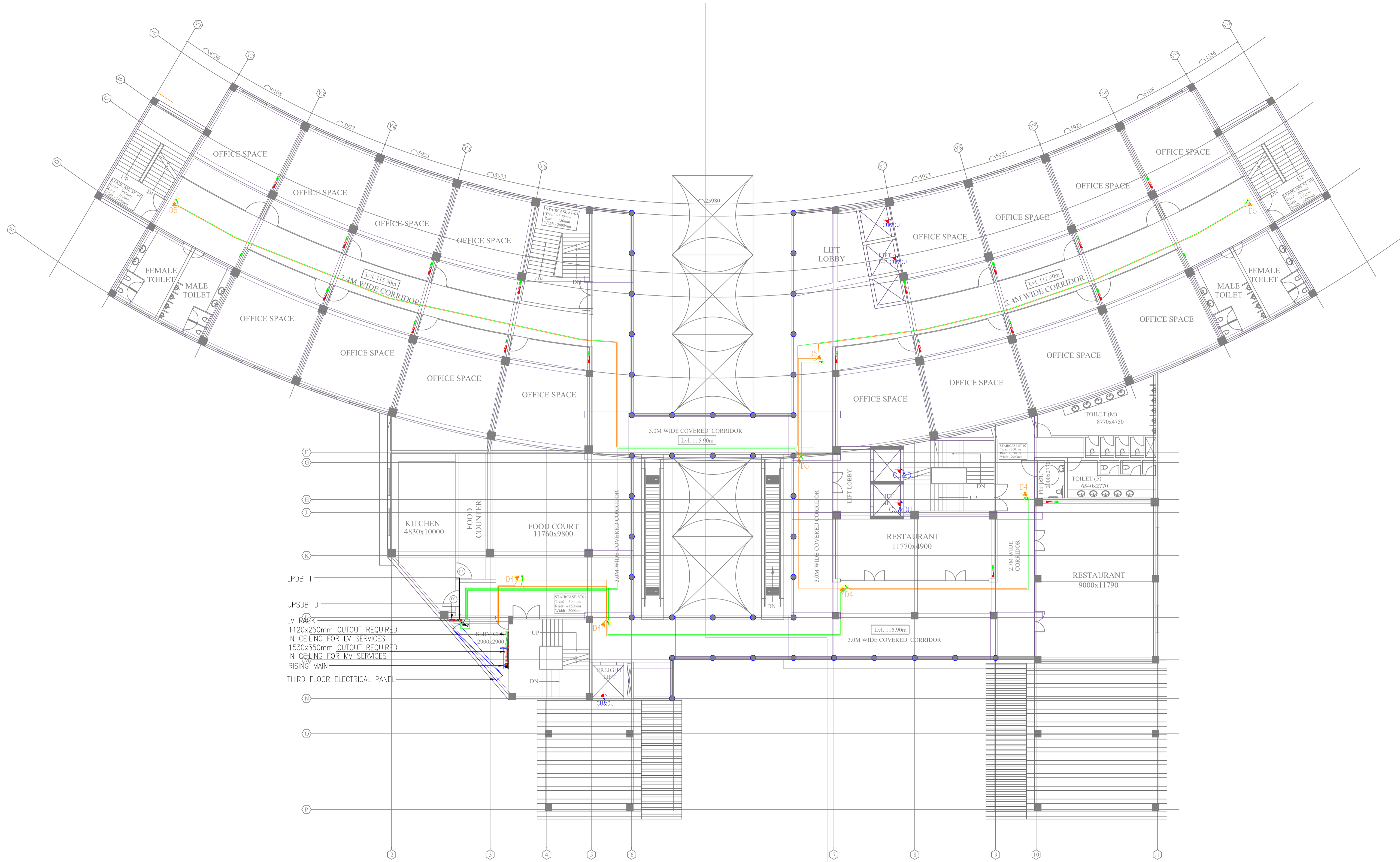

THIRD FLOOR PLAN

**NOTES FOR ELECTRICAL**

1. THE SIZE OF WIRES FROM SWITCH BOARD TO DIFFERENT LIGHT AND FAN POINTS SHALL BE 1.5 SQ. M.M.
2. 5 AMP. PLUG SHALL BE CONNECTED TO THE LIGHTING CKT. OF THAT AREA.
3. THE CONDUITS USED FOR WIRING SHALL BE AS FOLLOWS :  
SAME CONDUIT.  
a) HEAVY DUTY (2 MM THICK) : IN R.C.C. SLAB  
b) MEDIUM DUTY (1.5 MM THICK) : IN BRICK WALL
4. NO TWO DIFFERENT PHASE CIRCUIT / WIRE SHALL RUN TOGETHER THROUGH
5. LIGHT AND POWER CIRCUIT SHALL BE DRAWN THROUGH SEPARATE CONDUIT.
6. WIRING SHALL BE CARRIED OUT AS PER COLOUR CODE I.E. R, Y, B PHASES AND BLACK - NEUTRAL AND GREEN - EARTH.
7. THE POSITION MENTIONED IN LEGEND IS BOTTOM OF SWITCH BOARD / OUTLETS.
8. 230MM THICK WALL REQUIRED FOR DB MOUNTING.

